

- NOTES
1. Any dimensions scaled from this drawing are taken at the readers own risk.
  2. All dimensions are in mm unless stated otherwise.
  3. Weight Loading of 72kg/m<sup>2</sup>

**Front Elevation**

Scale 1:20

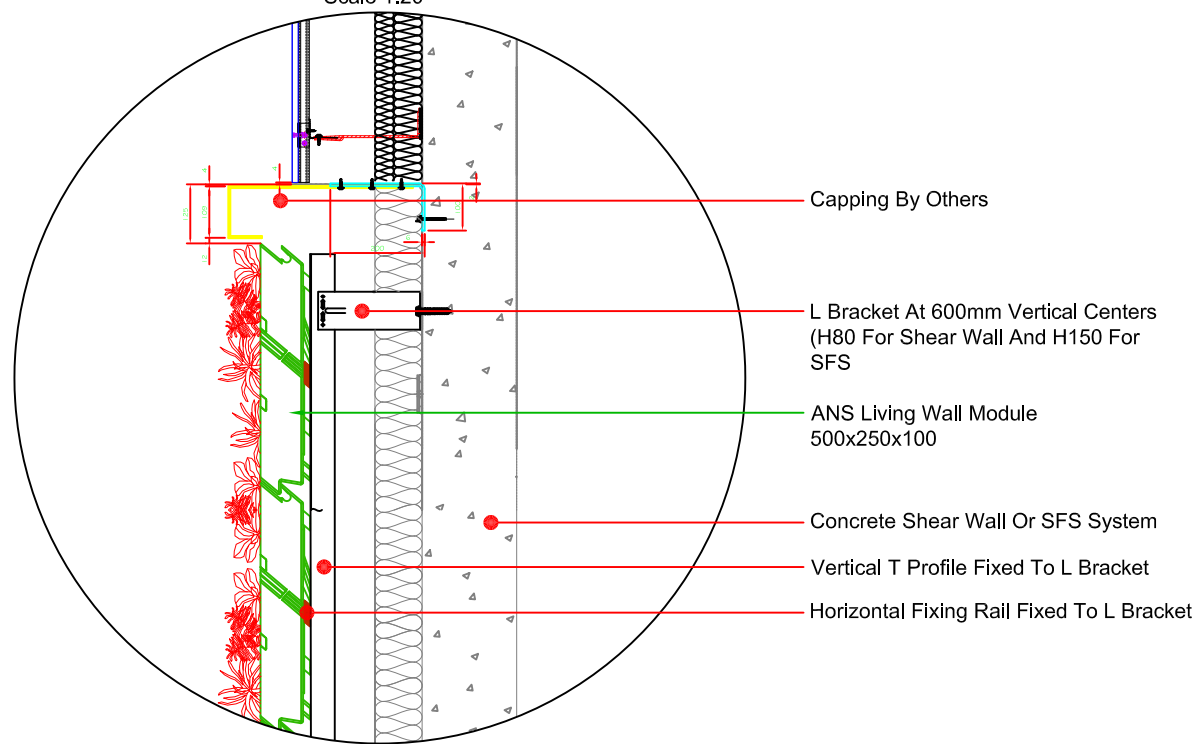

**Bottom Section**

Scale 1:10

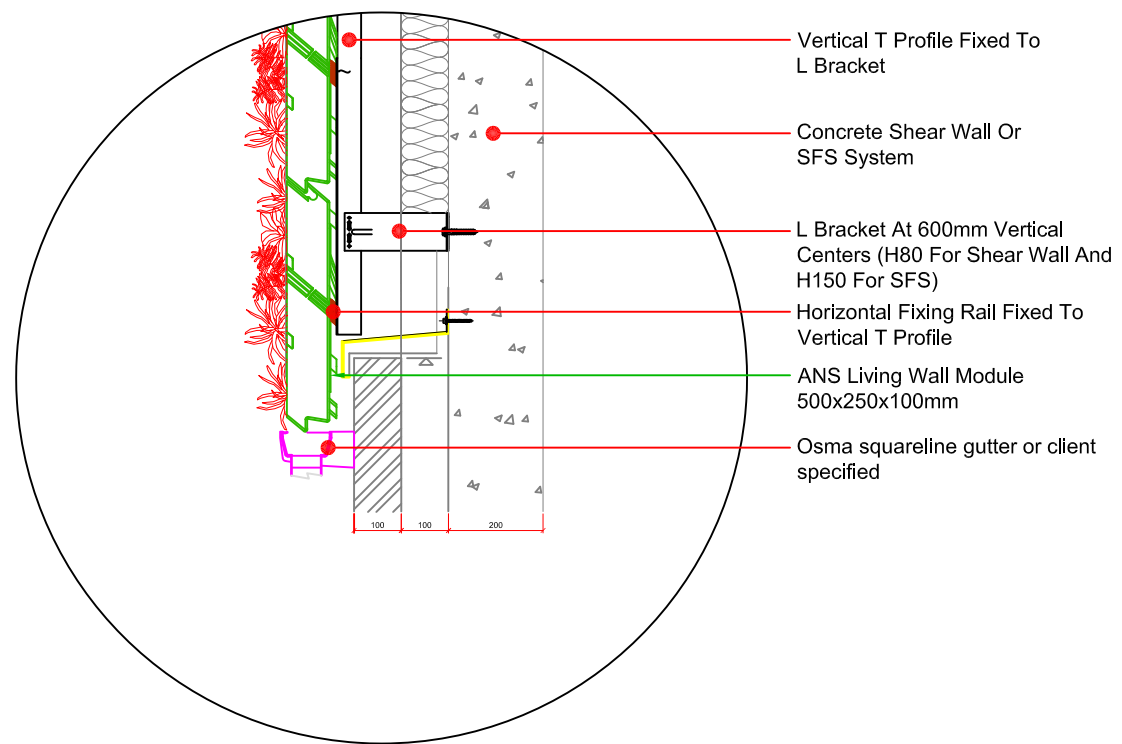

**Top Section**

Scale 1:10