

NOTES

1. Any dimensions scaled from this drawing are taken at the readers own risk.
2. All dimensions are in mm unless stated otherwise.
3. Weight Loading of 72kg/m<sup>2</sup>

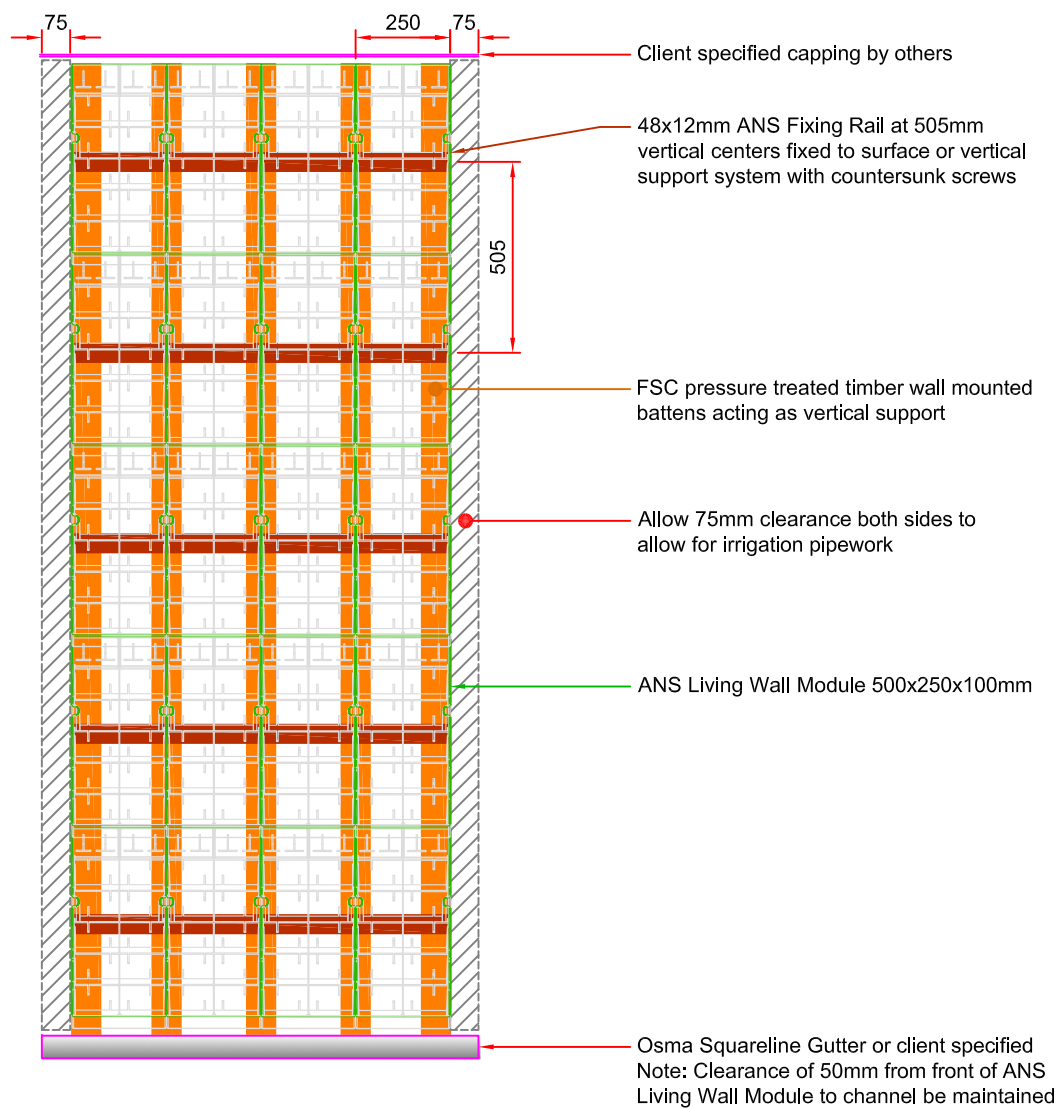

**Front Elevation**

Scale 1:20

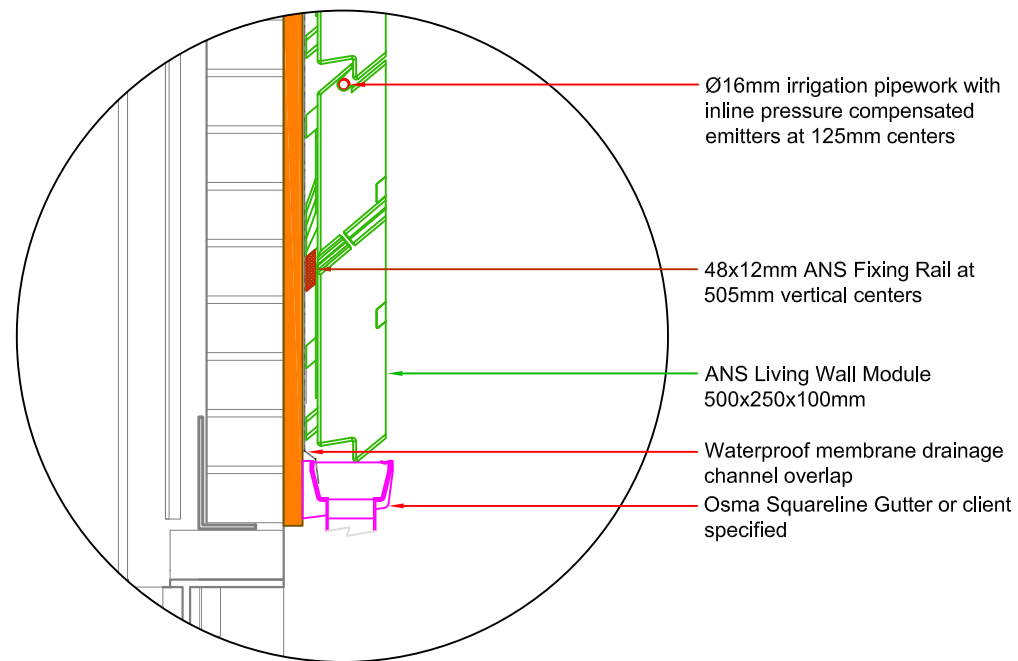

**Bottom Section**

Scale 1:10

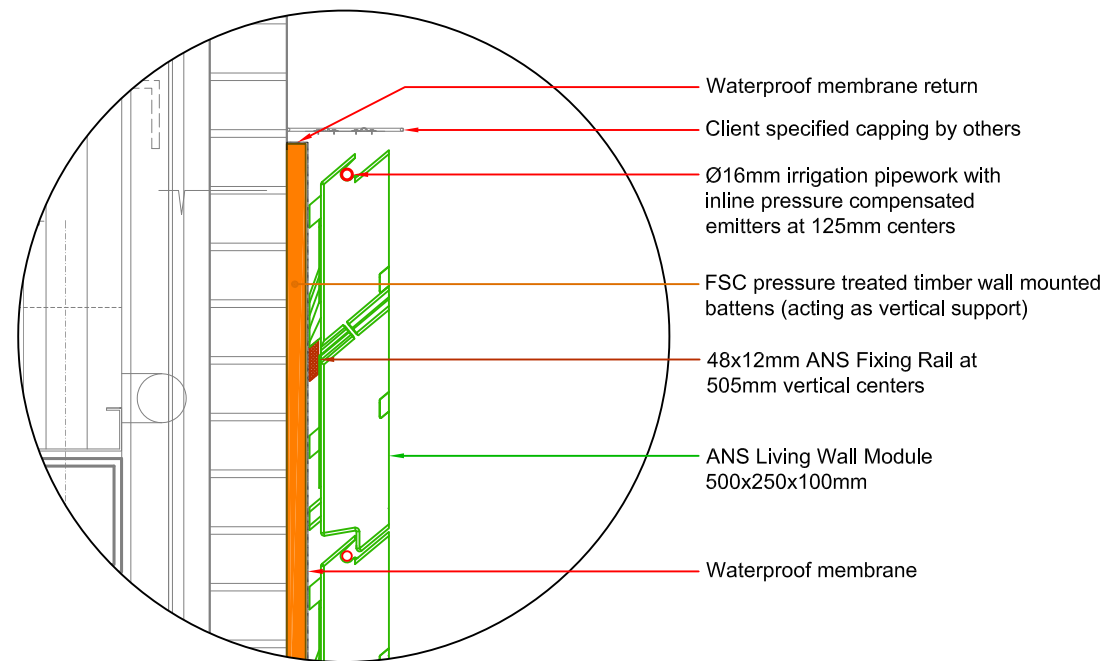

**Top Section**

Scale 1:10